

# UNIVERSAL CARPETS, INC.

## SITE PLAN

LAND LOTS - 62, 82 & 83, CITY OF ELLIJAY  
 11th DISTRICT - 2nd SECTION  
 GILMER COUNTY, GEORGIA

TAX PARCEL 1066-019  
 ZONING= GC (GENERAL COMMERCIAL)  
 TOTAL AREA = 43.26 ACRES

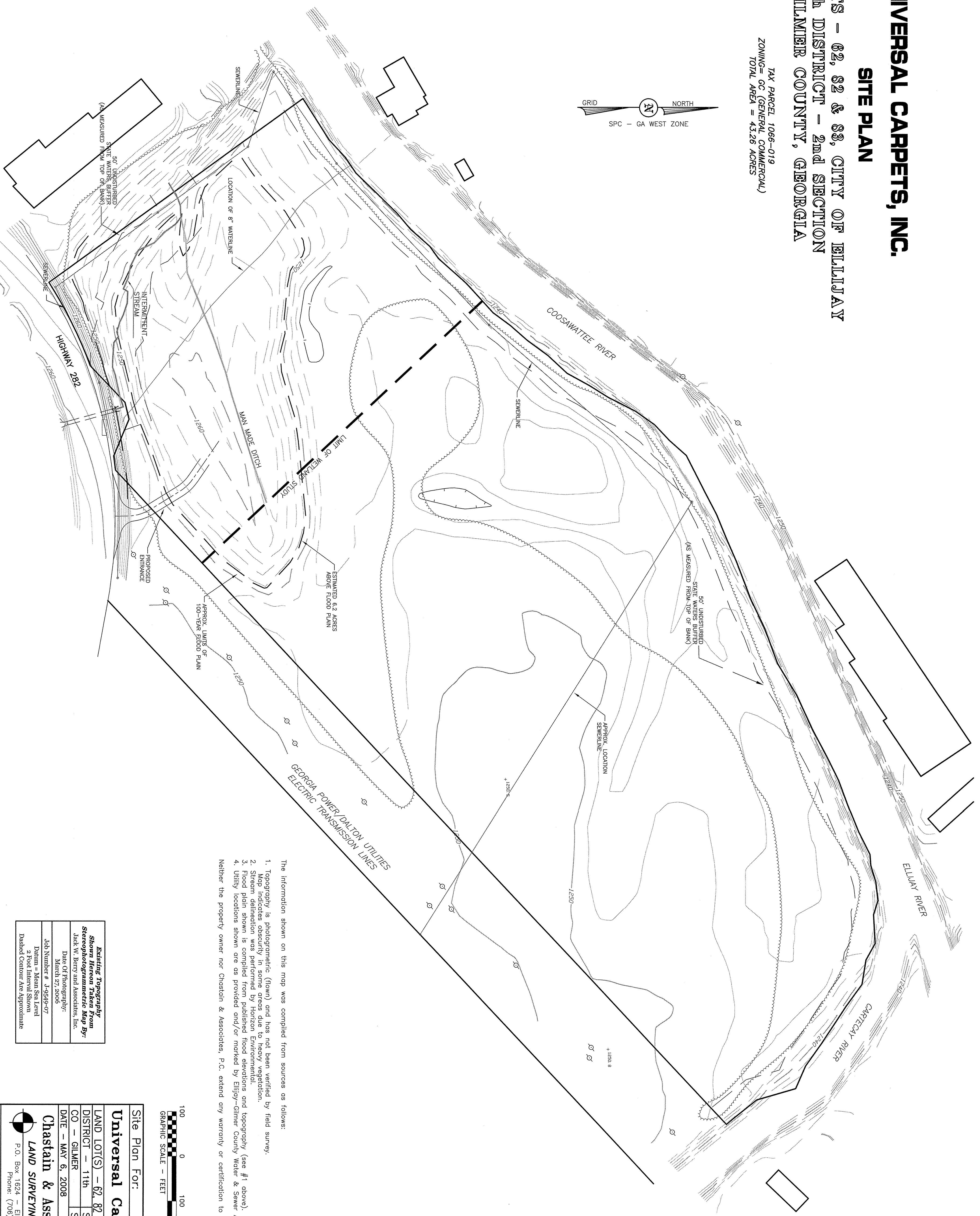

The information shown on this map was compiled from sources as follows:

1. Topography is photogrammetric (flown) and has not been verified by field survey.
2. Map indicates obscurity in some areas due to heavy vegetation.
3. Stream delineation was performed from Horizon Environmental.
4. Flood plain shown is compiled from published flood elevations and topography (see #1 above).
5. Utility locations shown are as provided and/or marked by Ellijay-Gilmer County Water & Sewer Authority.

Neither the property owner nor Chastain & Associates, P.C. extend any warranty or certification to these items.

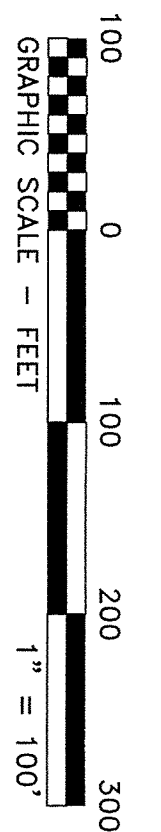

Site Plan For:  
**Universal Carpets, Inc.**

LAND LOT(S) - 62, 82 & 83, CITY OF ELLIJAY  
 DISTRICT - 11th SECTION - 2nd  
 CO - GILMER STATE - GEORGIA  
 DATE - MAY 6, 2008

**Chastain & Associates, P.C.**  
 LAND SURVEYING and PLANNING  
 P.O. Box 1624 - Ellijay, Georgia 30540  
 Phone: (706) 276-7528

PILOT FILE: 207750.SP SHEET 01 OF 01

<b>Existing Topography</b>	
Shown Hereon Taken From	
Stereophotogrammetric Map By:	
Jack W. Berry and Associates, Inc.	
Date Of Photography:	March 27, 2006
Job Number #	J-9549-07
Drawn - Mean Sea Level	
2 Foot Internal Show	
Dashed Contour Are Approximate	